



THIS DOCUMENT HAS BEEN DIGITALLY SIGNED AND SEALED BY:  
**Andrew Wisniewski**  
Date: 2025.04.25  
08:45:14 -05'00'

PRINTED COPIES OF THIS DOCUMENT ARE NOT CONSIDERED SIGNED AND SEALED. THE SIGNATURE MUST BE VERIFIED ON THE ELECTRONIC DOCUMENTS.

TENNESSEE DEPARTMENT OF TRANSPORTATION  
7345 REGION LN  
KNOXVILLE, TN 37914  
ANDREW WISNIEWSKI, P.E. 00114267

THE ABOVE NAMED PROFESSIONAL ENGINEER SHALL BE RESPONSIBLE FOR THE FOLLOWING SHEETS IN ACCORDANCE OF TENN. CODE ANN. §62-2-306.

SHEET NAME	SHEET NO.
SIGNATURE SHEETS.....	ROADWAY-SIGN2
ROADWAY INDEX AND STANDARD ROADWAY DRAWINGS.....	1A
ESTIMATED ROADWAY QUANTITIES .....	2
TABULATED QUANTITIES .....	2F1
EROSION PREVENTION AND SEDIMENT CONTROL PLANS.....	10
TRAFFIC CONTROL PLANS .....	T-3, T7 – T8

YEAR	PROJECT NO.	SHEET NO.
2025	46455-3414-04	ROADWAY-SIGN2

STATE OF TENNESSEE  
DEPARTMENT OF TRANSPORTATION

SIGNATURE  
SHEET







REV. 04-25-2025 - REMOVED ITEM  
NOS. 203-30.01 & 207-20.01. ADDED  
ITEM NOS. 203-01, 203-06, 203-07,  
203-10.15, 801-03 & 803-01. ADDED  
FOOTNOTES 20-24.

ESTIMATED ROADWAY QUANTITIES				
	ITEM NO.	DESCRIPTION	UNIT	QUANTITY
(1) (10) (20) (2) (21) (22) (23)	105-01	CONSTRUCTION STAKES, LINES AND GRADES	LS	1
	201-01	CLEARING AND GRUBBING	LS	1
	202-01	REMOVAL OF STRUCTURES AND OBSTRUCTIONS	LS	1
	203-01	ROAD & DRAINAGE EXCAVATION (UNCLASSIFIED)	C.Y.	1143
	203-06	WATER	M.G.	10
	203-07	FURNISHING & SPREADING TOPSOIL	C.Y.	68
	203-10.15	WASTE MATERIAL	C.Y.	564
(2) (4)	209-05	SEDIMENT REMOVAL	C.Y.	35
2) (3) (4) (11)	209-08.02	TEMPORARY SILT FENCE (WITH BACKING)	L.F.	873
(2) (4)	209-08.07	ROCK CHECK DAM	EACH	2
(2) (4) (13)	209-09.03	SEDIMENT FILTER BAG (15' X 15')	EACH	6
(2) (4)	209-65.04	TEMPORARY IN STREAM DIVERSION	L.F.	285
(15)	303-01	MINERAL AGGREGATE, TYPE A BASE, GRADING D	TON	612
(2) (4) (6)	303-10.01	MINERAL AGGREGATE (SIZE 57)	TON	20
	307-01.08	ASPHALT CONCRETE MIX (PG64-22) (BPMB-HM) GRADING B-M2	TON	131
	402-01	BITUMINOUS MATERIAL FOR PRIME COAT (PC)	TON	1.1
(2)	402-02	AGGREGATE FOR COVER MATERIAL (PC)	TON	6
	403-01	BITUMINOUS MATERIAL FOR TACK COAT (TC)	TON	0.4
	411-01.10	ACS MIX(PG64-22) GRADING D	TON	77
	604-10.51	SCARIFYING	S.Y.	834
(18)	607-05.30	24" PIPE CULVERT	L.F.	29
	607-39.02	18" PIPE CULVERT (SIDE DRAIN)	L.F.	103
	611-07.57	24IN ENDWALL (CROSS DRAIN) 3:1	EACH	2
	705-06.02	W BEAM GR (TYPE 2) MASH TL3 (LONG POST)	L.F.	50
	705-06.11	GR TERMINAL (IN-INLINE) MASH TL3	EACH	1
	705-06.26	THRIE BEAM BRIDGE TRANSITION MASH TL-2	EACH	4
	705-06.30	GR TERMINAL (ENERGY ABSORBING) MASH TL2	EACH	3
	706-01	GUARDRAIL REMOVED	L.F.	251
	706-10.26	ROUNDED END ELEMENT	EACH	1
(2) (4)	707-08.11	HIGH-VISIBILITY CONSTRUCTION FENCE	L.F.	340
(2) (4) (8)	709-05.05	MACHINED RIP-RAP (CLASS A-3)	TON	150
(2) (4) (7)	709-05.06	MACHINED RIP-RAP (CLASS A-1)	TON	215
(9)	709-05.09	MACHINED RIP-RAP (CLASS C)	TON	153
(14)	712-01	TRAFFIC CONTROL	LS	1
	712-02.02	INTERCONNECTED PORTABLE BARRIER RAIL	L.F.	50
(19)	712-02.60	TEMPORARY WORK ZONE CRASH CUSHION (MASH TL-3)	EACH	1
	712-04.01	FLEXIBLE DRUMS (CHANNELIZING)	EACH	40
	712-05.01	WARNING LIGHTS (TYPE A)	EACH	6
	712-06	SIGNS (CONSTRUCTION)	S.F.	357
	712-07.03	TEMPORARY BARRICADES (TYPE III)	L.F.	48
	712-09.04	REMOVABLE PAVEMENT MARKING (STOP LINE)	L.F.	24
(17)	713-15	REMOVAL OF SIGNS, POSTS AND FOOTINGS	LS	1
	713-16.20	SIGNS (R1-1 36" X 36" STOP SIGN)	EACH	1
	716-02.05	PLASTIC PAVEMENT MARKING (STOP LINE)	L.F.	30
	716-05.20	PAINTED PAVEMENT MARKING (6" LINE)	L.M.	0.31
	716-13.02	SPRAY THERMO PVMT MRKNG (60 mil) (6IN LINE)	L.M.	0.4
	717-01	MOBILIZATION	LS	1
(11)	730-40.02	TEMPORARY TRAFFIC SIGNAL SYSTEM	LS	1
(2) (4) (5)	740-10.03	GEOTEXTILE (TYPE III)(EROSION CONTROL)	S.Y.	464
(12)	740-10.04	GEOTEXTILE (TYPE IV)(STABILIZATION)	S.Y.	105
(2) (4)	740-11.01	TEMPORARY SEDIMENT TUBE 8IN	L.F.	250
(16)	801-01.07	TEMPORARY SEEDING (WITH MULCH)	UNIT	16
(12)	801-01.38	NATVE SEED MX FINAL STABILZATN OF SLOPES	UNIT	7
(24)	801-03	WATER (SEEDING & SODDING)	M.G.	5
	803-01	SODDING (NEW SOD)	S.Y.	250

## FOOTNOTES

- (1) REMOVE EXISTING PIPES, RETAINING WALL, AND OTHER OBSTRUCTIONS
- (2) QUANTITIES TO BE USED AS DIRECTED BY ENGINEER
- (3) 98 LF TO BE USED FOR SEDIMENT FILTER BAG
- (4) SEE SUBSECTION 209.07 OF THE STANDARD SPECIFICATION FOR MAINTENANCE REPLACEMENT.
- (5) 98 S.Y. TO BE USED FOR SEDIMENT FILTER BAGS  
258 S.Y. TO BE USED FOR TEMPORARY CONSTRUCTION EXITS  
108 S.Y. TO BE USED FOR CULVERT PROTECTIONS TYPE 1
- (6) 11 TONS TO BE USED FOR SEDIMENT FILTER BAG  
9 TONS TO BE USED FOR CULVERT PROTECTIONS TYPE 1
- (7) 46 TONS TO BE USED FOR CULVERT PROTECTIONS TYPE 1  
80 TONS TO BE USED FOR CROSS DRAIN EMBEDMENT AND REECE HILL DITCH  
89 TONS TO BE USED FOR SUBGRADE STABILIZATION. SEE GEOTECH SHEETS.
- (8) TO BE USED FOR TEMPORARY CONSTRUCTION EXIT
- (9) QUANTITY SUPPLIED BY STRUCTURES DIVISION
- (10) REFER TO SHEET 2F1 FOR QUANTITIES
- (11) INCLUDES THE TEMPORARY TRAFFIC SIGNAL SYSTEM FOR TRAFFIC AND THE USE OF A SIGNAL FOR THE DRIVEWAY TRAFFIC AS SPECIFIED IN THE PLANS
- (12) PERMANENT STABILIZATION WITH NATIVE OR NATURALIZED PERENNIAL VEGETATION IS REQUIRED IN ALL AREAS AUTHORIZED FOR TEMPORARY AND PERMANENT IMPACTS TO STREAMS AND RIPARIAN AREAS, INCLUDING ADJACENT BUFFER ZONES WITHIN 60 FT OF THE EDGE OF WATER. THE APPROPRIATE SEED MIXTURE FOR THE REGION AND SITE CONDITIONS SHALL BE SELECTED FROM TABLE 7.9-1 (PREFERRED SEED MIXES USING NATIVES OR NATURALIZED PLANTS AND PLANTING DATES) FOUND IN CHAPTER 7.9 (PERMANENT VEGETATION) OF THE TENNESSEE DEPARTMENT OF ENVIRONMENT AND CONSERVATION (TDEC) TENNESSEE EROSION & SEDIMENT CONTROL HANDBOOK 4TH EDITION.
- (13) INCLUDES 4 ADDITIONAL BAGS FOR REPLACEMENT AND/OR DIRECTED BY THE ENGINEER
- (14) FLAGGER TO BE USED AS WHERE DIRECTED BY ENGINEER
- (15) 90 TON TO BE USED FOR MAINTENANCE OF TRAFFIC AND 522 USED FOR BASE STONE
- (16) THE COST OF FERTILIZER AND LIME USED IN INTIAL SEED BED PREPARATION IS TO BE INCLUDED IN THE COST OF SEEDING. SEE SECTION 801 OF TDOT STANDARD SPECIFICATIONS FOR ROAD AND BRIDGE CONSTRUCTION.
- (17) INCLUDES COST OF POST
- (18) RCP CLASS III TO BE USED FOR CROSS DRAIN
- (19) TO BE USED AS DIRECTED BY ENGINEER
- (20) STRUCTURES TO BE REMOVED HAVE NO HISTORICAL SIGNIFICANCE AND NO PORTIONS THEREOF NEED TO BE SALVAGED OR PRESERVED.
- (21) SEE GRADING SPECIAL NOTES ON SHEET 2D.
- (22) INCLUDES 22 C.Y. FOR TEMPORARY CONSTRUCTION EXITS.
- (23) 1 M.G. FOR EMBANKMENT AND 9 M.G. FOR BASE MATERIAL.
- (24) INCLUDES 2 M.G. FOR EPSC AND 3 M.G. FOR SODDING.

**SEALED BY**

04-25-25

**STATE OF TENNESSEE**  
**DEPARTMENT OF TRANSPORTATION**

## ESTIMATED ROADWAY QUANTITIES



TYPE	YEAR	PROJECT NO.	SHEET NO.
R.O.W.	2022	46455-2414-04	2F1
PS&E	2025	46455-3414-04	2F1

REV. 04-25-2025 - REMOVED ROADWAY APPROACHES TAB BLOCK FROM SHEET.

ESTIMATED GRADING QUANTITIES						
DESCRIPTION	UNADJUSTED VOLUMES (CY)		ADJUSTED VOLUMES (CY)	BALANCE SUMMARY		
	EXC.	EMB.	EXC.	SHRINK =	20 %	SWELL = 20 %
MAINLINE	169	292	136	EXC.	915	VS. -378
SIDE ROADS	267	86	214			
PVT. DRIVES, BUSINESS AND FIELD ENTRANCES	14		12			
SUBGRADE STABILIZATION (GEOTECH)	83		67			
TEMPORARY CONSTRUCTION EXITS	22		18			
BRIDGE EXCAVATION	588		471			
TOPSOIL (EMB.)						
TOPSOIL (EXC.)				AVAILABLE	=	537
TOPSOIL TOTALS (SEE TOPSOIL TABLE)				WASTE MATERIAL	=	645
ROCK (C.Y.)		TOTALS (C.Y.)				
EXC.	EMB.	EXC. (UNCL.)	EMB. (UNCL.)	EXC (COMMON)	EXC. (AVAIL.)	EXC. (ADJ.)
		1143	378	1143	1143	915

REMOVAL OF STRUCTURES AND OBSTRUCTIONS				
SHEET NO.	STATION	LOCATION	DESCRIPTION	REMARKS
4	0+34.00	REECE HILL ROAD	18" RCP	
4	0+55.50	REECE HILL ROAD	12" RCP	
4	1+39.00	REECE HILL ROAD	12" RCP	
4	103+03.00 - 104+65.00	SLIMP BRANCH ROAD	STONE WALL	LEFT SIDE OF CL
4	0+15.00 - 0+40.00	REECE HILL ROAD	STONE WALL	LEFT SIDE OF CL

REMOVAL OF GUARDRAIL		
STATION RANGE	LOCATION	LENGTH (FT)
104+56.00 - 105+81.00	LT	125
104+54.00 - 105+80.00	RT	126

SEALED BY



04-25-25

STATE OF TENNESSEE  
DEPARTMENT OF TRANSPORTATION

TABULATED  
QUANTITIES



4/25/2025 8:04:44 AM  
\\AG03SDCWF00010.net.ads.state.tn.us\PROJECTS\Johnson\Slimp Branch Rd. Bridge over Roan Creek, LM 0.336\Bases Drawings\sheets\010.sht

TYPE	YEAR	PROJECT NO.	SHEET NO.
R.O.W.	2022	46455-2414-04	10
PS&E	2025	46455-3414-04	10

REV. 04-25-2025 - REMOVED ITEM NO. 207-20.01 AND ADDED ITEM NOS. 203-01 & 801-03.

TABULATED EPSC QUANTITIES				
	ITEM NO.	DESCRIPTION	UNIT	QUANTITY
(2) (6)	203-01	ROAD & DRAINAGE EXCAVATION (UNCLASSIFIED)	C.Y.	22
(1) (2)	209-05	SEDIMENT REMOVAL	C.Y.	35
(1) (2) (3)	209-08.02	TEMPORARY SILT FENCE (WITH BACKING)	L.F.	873
(1) (2)	209-08.07	ROCK CHECK DAM PER	EACH	2
(1) (2) (8)	209-09.03	SEDIMENT FILTER BAG (15' X 15')	EACH	6
(1) (2)	209-65.04	TEMPORARY IN STREAM DIVERSION	L.F.	285
(1) (2) (4)	303-10.01	MINERAL AGGREGATE (SIZE 57)	TON	20
(1) (2)	707-08.11	HIGH-VISIBILITY CONSTRUCTION FENCE	L.F.	340
(1) (2) (6)	709-05.05	MACHINED RIP-RAP (CLASS A-3)	TON	150
(1) (2) (7)	709-05.06	MACHINED RIP-RAP (CLASS A-1)	TON	46
(1) (2) (5)	740-10.03	GEOTEXTILE (TYPE III)(EROSION CONTROL)	S.Y.	464
(1) (2)	740-11.01	TEMPORARY SEDIMENT TUBE 8IN	L.F.	250
(9)	801-01.07	TEMPORARY SEEDING (WITH MULCH)	UNIT	16
(2)	801-03	WATER (SEEDING & SODDING)	M.G.	2

- (1) SEE SUBSECTION 209.07 OF THE STANDARD SPECIFICATION FOR MAINTENANCE REPLACEMENT
- (2) ITEM TO BE USED AS DIRECTED BY THE ENGINEER
- (3) 98 LF TO BE USED FOR SEDIMENT FILTER BAG
- (4) 11 TONS TO BE USED FOR SEDIMENT FILTER BAG  
9 TONS TO BE USED FOR CULVERT PROTECTIONS TYPE 1
- (5) 98 S.Y. TO BE USED FOR SEDIMENT FILTER BAGS  
258 S.Y. TO BE USED FOR TEMPORARY CONSTRUCTION EXITS  
108 S.Y. TO BE USED FOR CULVERT PROTECTIONS TYPE 1
- (6) TO BE USED FOR TEMPORARY CONSTRUCTION EXITS
- (7) TO BE USED FOR CULVERT PROTECTIONS TYPE 1
- (8) INCLUDES 4 ADDITIONAL BAGS FOR REPLACEMENT AND/OR AS DIRECTED BY THE ENGINEER
- (9) PREPARATION IS TO BE INCLUDED IN THE COST OF SEEDING. SEE SECTION 801 OF TDOT STANDARD SPECIFICATIONS FOR ROAD AND BRIDGE CONSTRUCTION.

EROSION PREVENTION AND SEDIMENT CONTROL LEGEND		
SYMBOL	ITEM	STD. DWG.
	SEDIMENT FILTER BAG	EC-STR-2
* SFB* SFB* SFB*	SILT FENCE WITH WIRE BACKING	EC-STR-3C
	ROCK CHECK DAM (V-DITCH)	EC-STR-6
	CULVERT PROTECTION (TYPE 1)	EC-STR-11
	TEMPORARY CONSTRUCTION EXIT	EC-STR-25
— IN — DIV —	INSTREAM DIVERSION	EC-STR-30 EC-STR-30A
** TUBE 6" ** TUBE 6" **	8 INCH SEDIMENT TUBE	EC-STR-37
* HVF * HVF *	HIGH VISIBILITY FENCE	S-F-1

1). J-HOOKS TO BE INSTALLED AT END OF A RUN OF SILT FENCE WHERE NOT PLACED ALONG CONTOURS

SEALED BY

04-25-25

STATE OF TENNESSEE  
DEPARTMENT OF TRANSPORTATION









EROSION  
PREVENTION  
AND SEDIMENT  
CONTROL NOTES

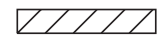

TYPE	YEAR	PROJECT NO.	SHEET NO.
PS&E	2025	46455-3414-04	T-3

REV. 04-25-2025 - REDUCED CRASH CUSHION QUANTITY.

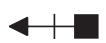
TABULATED TRAFFIC CONTROL QUANTITIES				
	ITEM NO.	DESCRIPTION	UNIT	QUANTITY
(2)	303-01	MINERAL AGGREGATE, TYPE A BASE, GRADING D	TON	90
(1)	712-01	TRAFFIC CONTROL	LS	1
	712-02.02	INTERCONNECTED PORTABLE BARRIER RAIL	L.F.	50
(4)	712-02.60	TEMPORARY WORK ZONE CRASH CUSHION (MASH TL-3)	EACH	1
	712-04.01	FLEXIBLE DRUMS (CHANNELIZING)	EACH	40
	712-05.01	WARNING LIGHTS (TYPE A)	EACH	6
	712-06	SIGNS (CONSTRUCTION)	S.F.	357
	712-07.03	TEMPORARY BARRICADES (TYPE III)	L.F.	48
	712-09.04	REMOVABLE PAVEMENT MARKING (STOP LINE)	L.F.	24
	716-05.20	PAINTED PAVEMENT MARKING (6" LINE)	L.M.	0.31
(3)	730-40.02	TEMPORARY TRAFFIC SIGNAL SYSTEM	LS	1
	(1)	FLAGGER TO BE USED AS WHERE DIRECTED BY THE ENGINEER		
	(2)	TO BE USED FOR MAINTAINENCE OF TRAFFIC		
	(3)	INCLUDES THE TEMPORARY TRAFFIC SIGNAL SYSTEM FOR TRAFFIC AND THE USE OF A SIGNAL FOR THE DRIVEWAY TRAFFIC AS SPECIFIED IN THE PLANS		
	(4)	TO BE USED AS DIRECTED BY ENGINEER		

TRAFFIC CONTROL LEGEND	
SYMBOL	ITEM
	WORK ZONE
	FLEXIBLE DRUMS (CHANNELIZING)
	SIGN (CONSTRUCTION)
	TRAFFIC FLOW
	PORTABLE BARRIER RAIL (WITH BARRIER RAIL DELINEATORS)
	TEMPORARY BARRICADE (TYPE III)
 A	WARNING LIGHT (TYPE A) (LOW-INTENSITY FLASHING)
	TRAFFIC SIGNAL HEAD
	TEMPORARY ATTENUATOR

TRAFFIC CONTROL SIGN TABULATION										
M.U.T.C.D. SIGN NO.	LEGEND	SIZE			S.F.	NO. REQUIRED PHASE 1	NO. REQUIRED PHASE 2	NO. REQUIRED PHASE 3	TOTAL NO. REQUIRED	ITEM NO. 712-06 S.F.
		IN INCHES								
		L	X	W						
D3-1	SLIMP BRANCH ROAD	36"	X	24"	6	15	15	15	15	90.00
G20-2	END ROAD WORK	36"	X	18"	5	3	3	3	3	13.50
M4-8A	END DETOUR	24"	X	12"	2	2	2	2	2	4.00
M4-9L	DETOUR WITH LEFT ARROW	30"	X	24"	5	3	3	3	3	15.00
M4-9R	DETOUR WITH RIGHT ARROW	30"	X	24"	5	3	3	3	3	15.00
R10-6	STOP HERE ON RED	24"	X	36"	6	2	2	2	2	12.00
R11-2	ROAD CLOSED	48"	X	30"	10	2	2	2	2	20.00
R11-3A	ROAD CLOSED 0.25 MILE AHEAD LOCAL TRAFFIC ONLY	60"	X	30"	13	1	1	1	1	12.50
W3-3	SIGNAL AHEAD	30"	X	30"	6	2	2	2	2	12.50
W3-4	BE PREPARED TO STOP	36"	X	36"	9	2	2	2	2	18.00
W20-1F	ROAD WORK 250 FT	36"	X	36"	9	1	1	1	1	9.00
W20-1F	ROAD WORK 500 FT	36"	X	36"	9	2	2	2	2	18.00
W20-1F	ROAD WORK 1000 FT	36"	X	36"	9	1	1	1	1	9.00
W20-1M	ROAD WORK 1/2 MILE	36"	X	36"	9	3	3	3	3	27.00
W20-3	ROAD CLOSED 500 FT	36"	X	36"	9	1	1	1	1	9.00
W20-3	ROAD CLOSED 1000 FT	36"	X	36"	9	1	1	1	1	9.00
W20-3	ROAD CLOSED AHEAD	36"	X	36"	9	4	4	4	4	36.00
W20-4F	ONE LANE ROAD 1500 FT	36"	X	36"	9	3	3	3	3	27.00
								TOTAL		357

SEALED BY



04-25-25

STATE OF TENNESSEE  
DEPARTMENT OF TRANSPORTATION

TRAFFIC CONTROL  
LEGEND AND  
TABULATION



TYPE	YEAR	PROJECT NO.	SHEET NO.
PS&E	2025	46455-3414-04	T-7

REV. 04-25-2025 - REMOVED ONE TEMPORARY ATTENUATOR AT BRIDGE END.

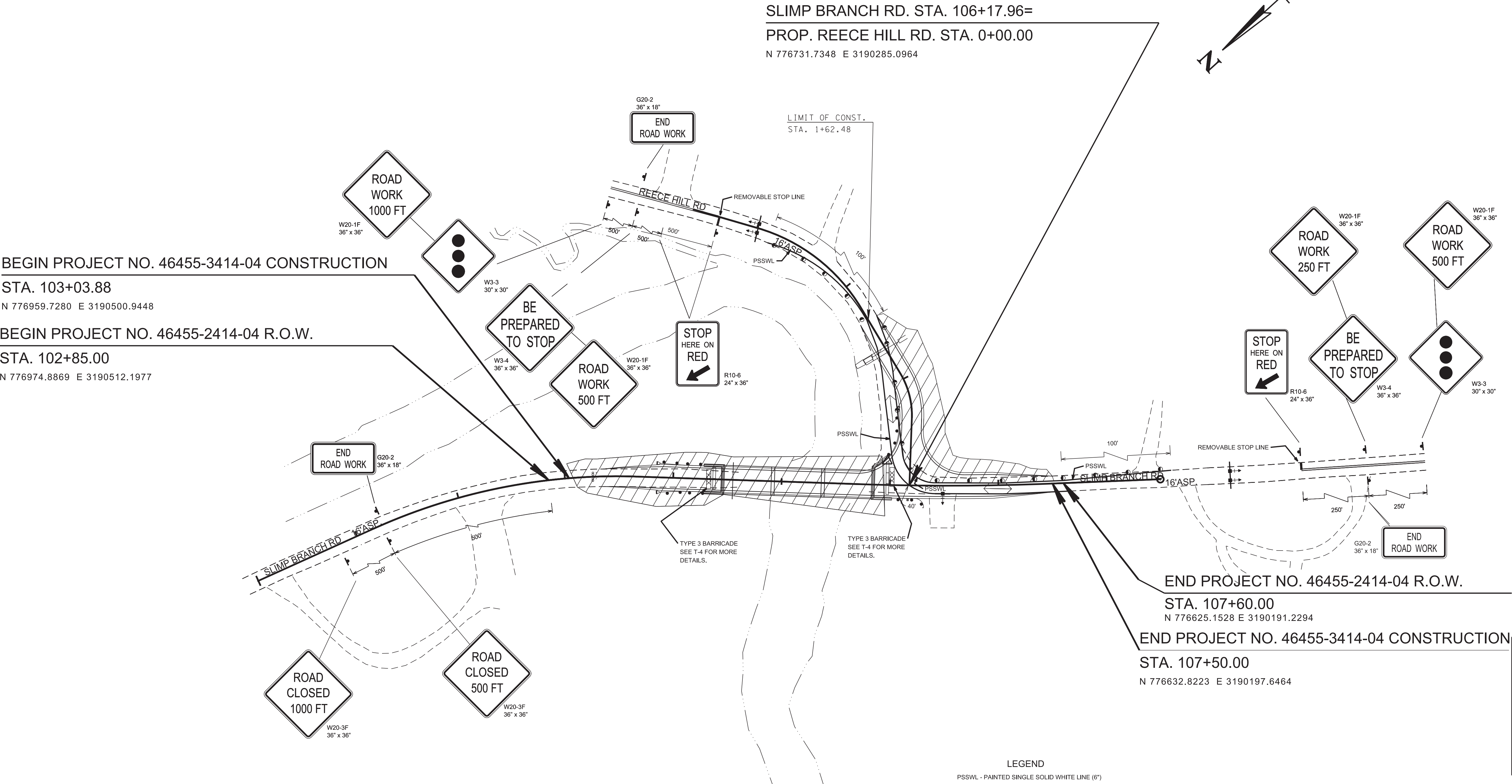

BEGIN PROJECT NO. 46455-3414-04 CONSTRUCTION  
STA. 103+03.88  
N 776959.7280 E 3190500.9448  
BEGIN PROJECT NO. 46455-2414-04 R.O.W.  
STA. 102+85.00  
N 776974.8869 E 3190512.1977

END PROJECT NO. 46455-2414-04 R.O.W.  
STA. 107+60.00  
N 776625.1528 E 3190191.2294  
END PROJECT NO. 46455-3414-04 CONSTRUCTION  
STA. 107+50.00  
N 776632.8223 E 3190197.6464

PHASE 2

REFER TO STANDARD DRAWINGS T-WZ-10, T-WZ-32 THROUGH T-WZ-35 AND OTHER STANDARD DRAWINGS NOTED ON SHEET 1A.

PHASE 2 CONSTRUCTION WORK ZONE

SEALED BY

COORDINATES ARE NAD 83(1995), ARE DATUM ADJUSTED BY THE FACTOR OF 1.0001 AND TIED TO THE TGRN. ALL ELEVATIONS ARE REFERENCED TO THE NAVD 1988 WITH GEOID 12B.

STATE OF TENNESSEE  
DEPARTMENT OF TRANSPORTATION

TRAFFIC CONTROL PLANS  
STA.99+99.03 TO STA.108+49.53  
NTS

TYPE	YEAR	PROJECT NO.	SHEET NO.
PS&E	2025	46455-3414-04	T-8

REV. 04-25-2025 - REMOVED ONE TEMPORARY ATTENUATOR AT BRIDGE END.

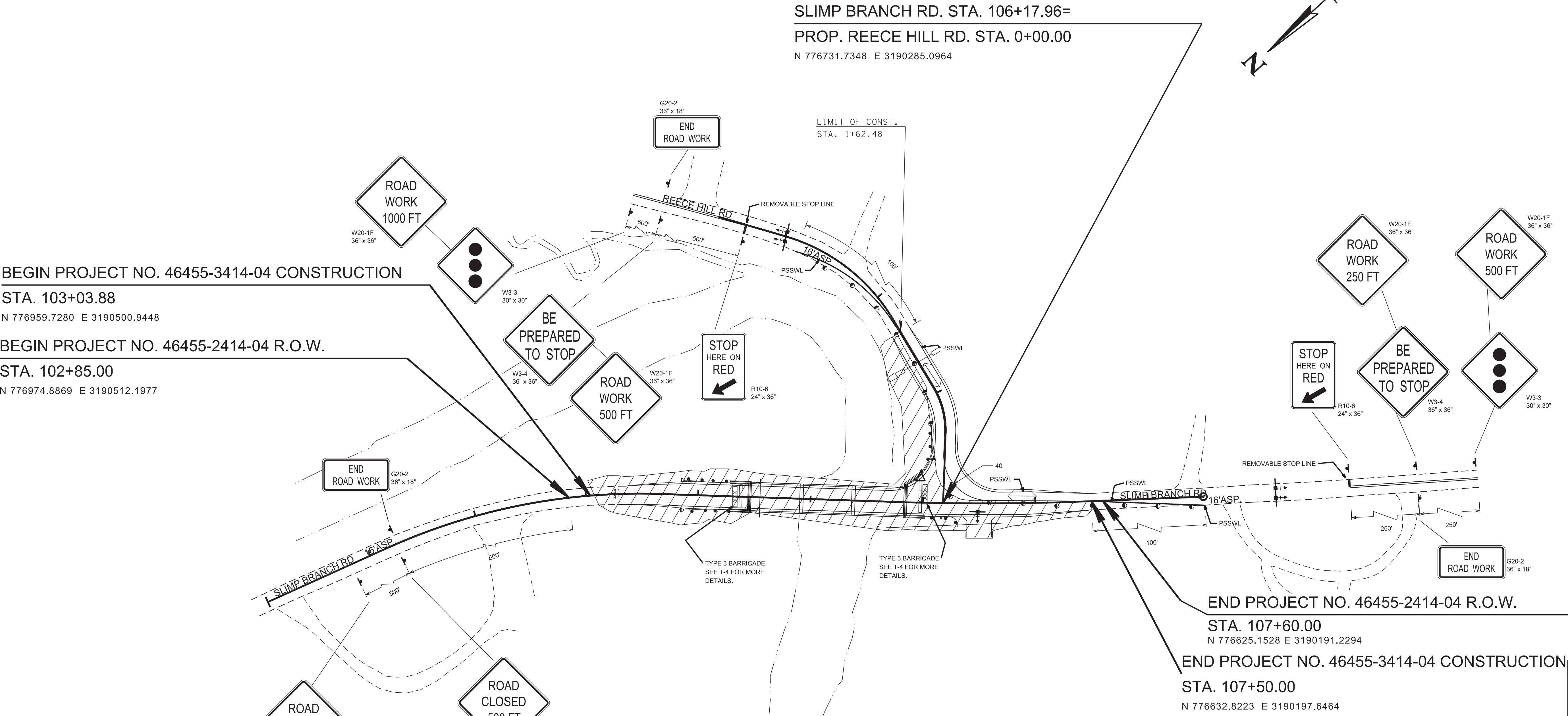

BEGIN PROJECT NO. 46455-3414-04 CONSTRUCTION  
STA. 103+03.88  
N 776959.7280 E 3190500.9448  
BEGIN PROJECT NO. 46455-2414-04 R.O.W.  
STA. 102+85.00  
N 776974.8869 E 3190512.1977

END PROJECT NO. 46455-2414-04 R.O.W.  
STA. 107+60.00  
N 776625.1528 E 3190191.2294  
END PROJECT NO. 46455-3414-04 CONSTRUCTION  
STA. 107+50.00  
N 776632.8223 E 3190197.6464

LEGEND  
PSSWL - PAINTED SINGLE SOLID WHITE LINE (6")

PHASE 3

REFER TO STANDARD DRAWINGS T-WZ-10, T-WZ-32 THROUGH T-WZ-35 AND OTHER STANDARD DRAWINGS NOTED ON SHEET 1A.

 PHASE 3 CONSTRUCTION WORK ZONE

SEALED BY

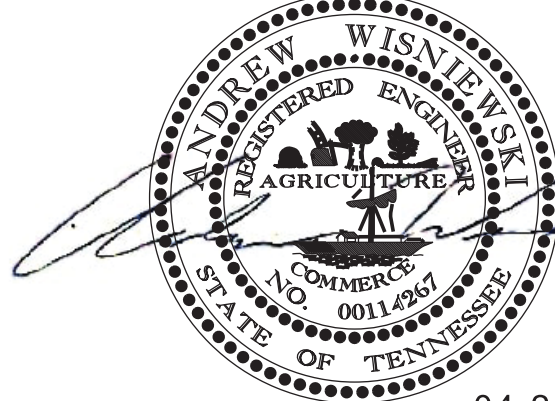

04-25-25

COORDINATES ARE NAD 83(1995), ARE DATUM ADJUSTED BY THE FACTOR OF 1.0001 AND TIED TO THE TGRN. ALL ELEVATIONS ARE REFERENCED TO THE NAVD 1988 WITH GEOID 12B.

STATE OF TENNESSEE  
DEPARTMENT OF TRANSPORTATION

TRAFFIC CONTROL PLANS  
STA.99+99.03 TO STA.108+49.53  
NTS

4/25/2025 8:07:49 AM  
\\AG03SDCWF00010.net\ads.state.tn.us\PROJECTS\Johnson\Slimp Branch Rd. Bridge over Roan Creek, LM 0.336\Bases Drawings\sheets\T-8.sht